



The Library

First Floor

Hume Rothery Building

## CONTACT

Librarian

Grace Sewell

**library@materials.ox.ac.uk**

Tel no. (01865) 2-73697

Academic Librarian

Professor James Marrow

# The Library

## Department of Materials

The Library here within the Department, along with the Radcliffe Science Library and your College library provide a wide range of library services to meet the needs of students, academics and research community.

The **Radcliffe Science Library** – part of the Bodleian Libraries - is the main library providing services to support the science community at Oxford. Later in this presentation my colleague from the RSL, Alessandra will give you further details about SOLO and present a virtual tour.

### **College Libraries**

Please visit and make yourself aware of the collections available to you.

Where is the Library?

The Library is on the first floor of the Hume-Rothery Building on Parks Road

Library layout

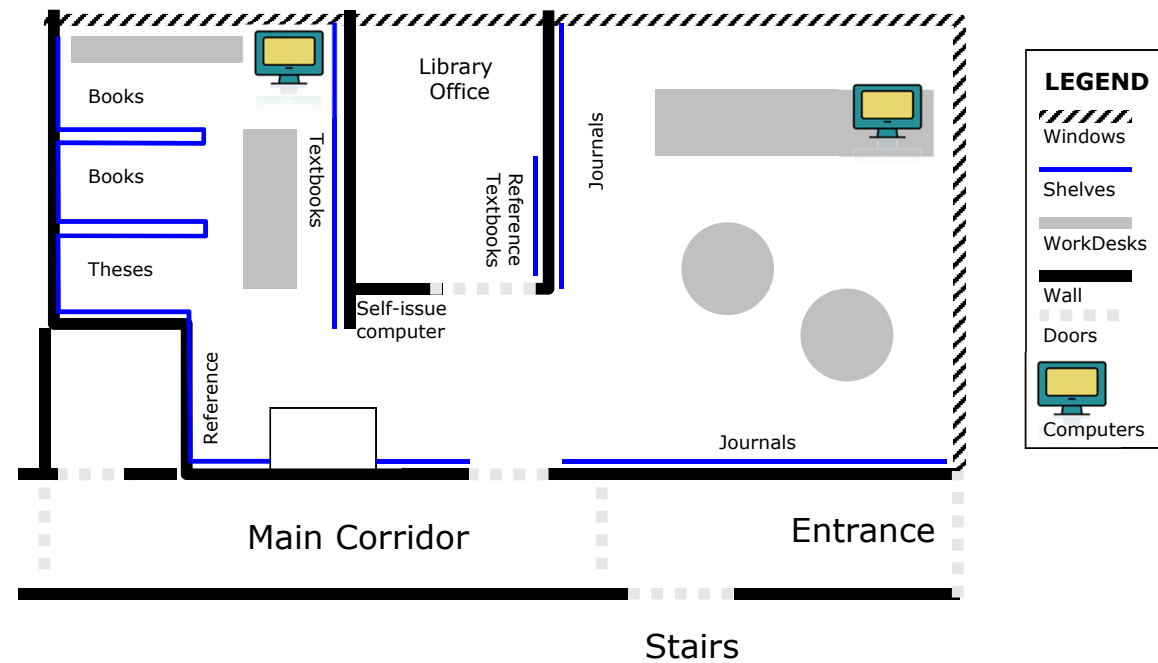

# Book Room



# Journal Room



# Useful Links

**COVID-19**, there are some changes and additional procedures to follow when in the library.

<https://www.materials.ox.ac.uk/library-arrangements-guidance-use-mt20>

## Finding Resources

<http://solo.bodleian.ox.ac.uk/primo-explore/search?vid=SOLO>



**The Main search engine for Library collections and resources**

**SOLO** (Search Oxford Libraries Online) providing access to resources available in the Department, College and Central University of Oxford libraries. It offers a one-stop search and delivery solution for quickly accessing Oxford's main library information resources regardless of type, format or location.



# https://libguides.bodleian.ox.ac.uk/materials

SOLO: Search Oxford Libraries

Searching University of Oxford

Subjects A-Z - Oxford LibGuides

Home - Research Guide for Materials Science

libguides.bodleian.ox.ac.uk/materials



Subject guides • Workshops • Research skills



[Bodleian Libraries](#) / [Oxford LibGuides](#) / [Research Guide for Materials Science](#) / [Home](#)

Research Guide for Materials Science: Home

Subjects: [Engineering](#), [Materials](#), [Patents](#)

Home

Books and e-books

Journals and Conference Proceedings

Databases

Keeping up-to-date

Standards, technical repositories, etc

Web resources

Dissertations

Patents

Open access

Research Data Management

Managing your references

Training

**Radcliffe Science Library**

The [Radcliffe Science Library](#) is the main research library, one of the Bodleian Libraries in Oxford. RSL provides reference and lending collections of printed materials and extensive collections of electronic resources for all science subjects taught and researched at University.

Visit our web site to learn about library services, reading rooms and spaces, computer facilities, 3D printing services, teaching and research support through enquiries, subject librarians consultations, research support, and training courses

**Departmental Library**

The departmental Library is located in the Materials Science Department.

Information about Admission, Opening Hours and collections  
<http://www.materials.ox.ac.uk/local/library.html>

Contact departmental librarian:  
[library@materials.ox.ac.uk](mailto:library@materials.ox.ac.uk)

**Radcliffe Science Library temporary closure**

The Radcliffe Science Library building is now closed for refurbishment until summer 2021. The Bodleian Libraries science library services will operate the [Vere Harmsworth Library](#) while work on redeveloping the RSL takes place. More information is available here - <https://www.bodleian.ox.ac.uk/science/rsl-refurbishment>

Please find more information about the Science Libraries Services in the VHL here:  
<https://www.bodleian.ox.ac.uk/science/rsl-at-vhl>

**Electronic resources for Materials Science**

This guide provides links to research information sources for Materials Science.

If you are starting a project or a dissertation, you will need to find information about previous publications in your research field.

Start by searching electronic **databases** such as SciFinder on the Web. Bibliographic databases index thousands of journals and provide references to journal articles, books, conference proceedings, technical reports ...

Search **SOLO** discovery platform to find printed books, and other materials, e-books, and other electronic materials.

**Graduate Inductions and Training - Hilary Term 2020**

All graduate induction and Research Skills training sessions have been arranged with Departments and will be delivered online.

[Bodleian iSkills Workshops](#) training provide general sessions for all students and researchers at University of Oxford.

**Physical Sciences Librarian**



**Alessandra Vetrugno**

Contact:  
+44 (0)1865 272817

**Search SOLO**



Use the SOLO catalogue to search the Oxford Libraries collection

FileEditViewHistoryBookmarksToolsHelp

SOLO - Search Oxford Libraries xInduction - Bodleian Libraries R xSOLO - Search Oxford Libraries xSOLO: Search Oxford Libraries x

←→↻🏠soloadleian.ox.ac.uk/primo-explore/fulldisplay?docid=oxfaleph013749972...🔍Search

⚙️Most Visited🔗Getting Started📖Libraries Control System📄Swetwise📄PQ ProQuest Dissertation...🔗Log On to Aleph Repo...

SOLO  
SEARCH OXFORD  
LIBRARIES

topics

Sort

Sort

Show

On

Ph

Libra

Reso

Creat

Publ

From

1995



BOOK

Topics in electron diffraction and microscopy of materials

Hirsch, P. B. (Peter Bernhard)

1999 | Bristol : Institute of Physics Pub. | xii, 196 p. : ill. ; 24 cm

Find & Request >

TOP

EXPORT OPTIONS

FIND & REQUEST

DETAILS & LINKS

LINKS

MORE

BROWSE RELATED

TAGS

Export Options

REFWORKS

ENDNOTE

RIS

CITATION

PERMALINK

PRINT

E-MAIL

Find & Request

Please sign in to see request options and to place requests. [Sign In](#)

[BACK TO LOCATIONS](#)

LOCATION ITEMS

Dept of Materials Library ⓘ

32 HIR

Books 300991730

Available

▼

32 HIR

Books 306493514

Available

▼

Librarian's Office

Details & Links

Title

Topics in electron diffraction and microscopy of materials

🏠Type here to search



10:46  
03/09/2018

**Dept of Materials Library**

**32 HIR**

Books 300991730

Available

Location: Dept of Materials Library

Status: Books Available

Item Type: Book

**32 HIR**

**Librarian's Office**

Books 306493514

Available

Location: Dept of Materials Library Librarian's Office

Status: Books Available

Item Type: Book

# Self Issue





## HOW TO BORROW A BOOK

The Library operates an electronic Self-issue system, this means that you will be charging out your own books.

You will need your University card.

To borrow a book scan the bar-code on your University card and then the barcode on the first page of the book.

There is on screen help and printed notices beside the computer to assist you

If there are problems using the system please email

[library@materials.ox.ac.uk](mailto:library@materials.ox.ac.uk) with the details of the items

## Loan periods are listed below.

When the item is due you will receive, via email, an overdue notice.

Please respond by either returning the item or renewing it.

Senior Academic Staff	three months
Research Fellows, Visitors, Post-docs	six weeks
<u>Graduates/4th year students</u>	<u>four weeks</u>
Undergraduates	two weeks
Readers from other departments	one week

# ***Library etiquette***

The following guidelines are to ensure the library runs smoothly and remains a useful resource for all **Covid 19 guidance** on using the Library (Please see full details at Website the [Internal](#) tab).

All members of the department are entitled to use the library, but **must abide by the occupancy rules**, ie:

Journal room: no more than 4 people at any one time

Foyer: a maximum of 1 person only

Book Room: no more than 2 people at any one time

During Michaelmas Term 2020 please do not use the library as a place for self-study - all visits should be brief and last as long as it takes to consult periodicals and/or borrow books.

**Remember to scan** the QR code as you arrive, using the [NHS COVID-19 app](#). If you cannot (or prefer not to) scan the code, please email [library@materials.ox.ac.uk](mailto:library@materials.ox.ac.uk) with your name, date and time of your visit. This is essential to ensure the Government's track and trace procedure can operate properly.

Please use the self-issue machine to borrow **all** items, even when you are taking them to the Labs, your office or the Common Room

Overdue notices are sent out automatically. Please respond promptly.

When returning items please deposit in the book returns box located in the main foyer area. Please follow the instructions on depositing the items.

## TRAINING

***Fri 23 Oct 10.30-11:30***

INFORMATION SKILLS WORKSHOP (Alessandra Vetrugno)

***Via Teams***

***,***



My working days are  
Monday and Tuesday (am – off site)  
Thursday 11:00 – 15:00 - onsite

If you have any questions or need any assistance please do  
email me

[library@materials.ox.ac.uk](mailto:library@materials.ox.ac.uk)